

READING BOROUGH COUNCIL

REPORT BY DIRECTOR OF ENVIRONMENT AND NEIGHBOURHOOD SERVICES

TO:	TRAFFIC MANAGEMENT SUB-COMMITTEE		
DATE:	14 JANUARY 2016	AGENDA ITEM:	11
TITLE:	UNIVERSITY & HOSPITAL AREA STUDY - UPDATE		
LEAD COUNCILLOR:	TONY PAGE	PORTFOLIO:	STRATEGIC ENVIRONMENT, PLANNING AND TRANSPORT
SERVICE:	TRANSPORTATION AND STREETCARE	WARDS:	REDLANDS
LEAD OFFICERS:	CRIS BUTLER CHRIS MADDOCKS	TEL:	0118 937 2068 0118 937 2138
JOB TITLE:	STRATEGIC TRANSPORTATION PROGRAMME MANAGER TRANSPORT PLANNING MANAGER	E-MAIL:	Cris.butler@reading.gov.uk Chris.Maddocks@reading.gov.uk

1. EXECUTIVE SUMMARY

- 1.1 The purpose of this report is to update the Sub-Committee on the latest position with regard to the identification of transport issues and potential solutions in the residential areas around the University of Reading and Royal Berkshire Hospital.
- 1.2 A consultation was undertaken in May 2012 on the principle of prioritising parking for local residents through introducing a Residents' Parking Scheme, to include elements of pay and display parking, alongside complementary transport measures in the local area. The scheme was proposed to help address the issues previously identified by residents through the study.
- 1.3 Due to the mixed nature of responses received through the consultation, the study Steering Group took the decision not to proceed with the proposed parking scheme at that time. It was agreed that the study would continue working closely with key stakeholders, including the University and Hospital, to reassess the feasibility of introducing the complementary transport schemes as outlined in the consultation and as supported through feedback received from residents.

- 1.4 This work has continued over the past few years, and alongside detailed discussions with key stakeholders, a second set of proposals has recently been completed. A local consultation including a local exhibition has since taken place in September and October 2015 by the Redlands Ward Councillors on the latest plans.
- 1.5 The results of the consultation have been reviewed, and liaison with key stakeholders such as the Emergency Services has been completed. This report provides an update on the proposed next steps.
- 1.6 Appendix 1 - Proposals East of Alexandra Road
Appendix 2 - Proposals West of Alexandra Road (inc Alexandra Road)
Appendix 3 - Equality Impact Assessment - Scoping Report

2. RECOMMENDED ACTION

- 2.1 That the Sub-Committee note the report.
- 2.2 That in consultation with the Chair of the Sub-Committee, the Lead Councillor for Strategic Environment, Planning and Transport and Ward Councillors, the Head of Legal and Democratic Services be authorised to carry out a statutory consultation on the proposed new waiting restrictions as shown in Appendix 2 and in accordance with the Local Authorities Traffic Orders (Procedure) (England and Wales) Regulations 1996.
- 2.3 That subject to no objections received, the Head of Legal and Democratic Services be authorised to make the Traffic Regulation Order.
- 2.4 That any objections received following the statutory consultation be reported to a future meeting of the Sub-Committee.
- 2.5 That in consultation with the Lead Councillor for Strategic Environment, Planning and Transport and Ward Councillors, that the Head of Transportation and Streetcare be authorised to make minor alterations to the proposals following the Statutory Consultation process.
- 2.6 That the proposals shown in Appendix 1 are progressed no further.

3. POLICY CONTEXT

- 3.1 To secure the most effective use of resources in the delivery of high quality, best value public service.

4. THE PROPOSAL

- 4.1 Reading's transport strategy is contained within the LTP 2011-2026, which reviews challenges and opportunities throughout Reading and proposes Local Action Plans to be developed in neighbourhoods to address these challenges. These Action Plan Areas are based on a division of the urban area identified in the LTP 2006-2011, and represent continuity in implementing multi-targeted transport measures throughout Reading.
- 4.2 The LTP's vision is based on the vision for Reading set out in the Sustainable Communities Strategy by the Local Strategic Partnership. The vision is supported by a number of overarching objectives and enabling policies, which are in turn supported by detailed policies and objectives on a variety of themes, from cycling and parking to road safety and travel information. The policies and objectives for each theme are designed to help identify actions to address issues in local neighbourhoods.
- 4.3 In line with the LTP, a consultation was undertaken in May 2012 on the principle of prioritising parking in the Hospital and University area for local residents through introducing a Residents' Parking Scheme, to include elements of pay and display parking, alongside complementary transport measures in the local area. The scheme was proposed to help address the issues previously identified by residents through the study.
- 4.4 Due to the mixed nature of responses received through the consultation, the study Steering Group took the decision not to proceed with the proposed parking scheme at that time. It was agreed to continue with the study and focus on continuing to work closely with key stakeholders, including the University and Hospital, to reassess the feasibility of introducing the complementary transport schemes as outlined in the consultation and as supported through feedback received from residents.
- 4.5 This work has continued over the past few years, and recently, a second set of proposals were prepared by the Council and presented for consultation by the Redlands Ward Councillors.
- 4.6 Redlands Ward Councillors promoted the latest set of proposals via a local leaflet delivered to all properties in the study area, information on the Redlands Councillors website, and a local exhibition took place at St Lukes Church Hall on Monday 28 September 2015 between 5:00pm to 7:00pm supported by Council Transport Officers.

East of Alexandra Road Proposals

- 4.7 The proposed residents parking schemes in Foxhill Road, Cardigan Road, Cardigan Gardens, Donnington Road, Donnington Gardens, Blenheim Road, Blenheim Gardens, and Hatherley Road are intended as parking protection for residents due to the likelihood of displacement from the Hospital and University areas where a change in restriction is proposed. These proposals are shown in Appendix 1.

- 4.8 These roads are narrow, and whilst parking is currently unrestricted and commonly seen on both sides of the road, formalising parking will include the requirement to maintain access for emergency services and larger vehicles such as refuse vehicles at all times. This will change the way in which vehicles can park and in some cases parking can only be provided on one side of the road due to the available road space.
- 4.9 The majority of feedback from residents at the local exhibition was focused on the reduction in parking spaces in the areas as explained in paragraph 4.7 and 4.8 above. A review of the written feedback received from residents also focused on this area, with the majority objecting to such a scheme progressing.
- 4.10 Officers have also completed the review of the proposals alongside the Emergency Services and have concluded that the proposed parking protection scheme in the roads listed in paragraph 4.7 above cannot be altered any further in order to increase parking provision with a formalized parking scheme.
- 4.11 It is therefore recommended that no further action be taken in these roads as part of this exercise, and any future issues be considered on a road by road basis alongside detailed liaison with the Ward Councillors.

West of Alexandra Road Proposals (Inc Alexandra Road)

- 4.12 The proposals detailed in Alexandra Road and to the west include new areas of pay and display parking and residents parking in order to create a managed parking scheme to improve parking allocation and turnover. The proposals are shown in Appendix 2.
- 4.13 Feedback on these ideas was in general positive, and it is therefore recommended that the proposals are progressed to the formal three week Statutory Consultation and any objections be reported to a future meeting of the Traffic Management Sub-Committee.

5. CONTRIBUTION TO STRATEGIC AIMS

- 5.1 The delivery of the projects outlined in this report help to deliver the following Corporate Plan Service Priorities:
- Keeping the town clean, safe, green and active.
 - Providing infrastructure to support the economy.

6. COMMUNITY ENGAGEMENT AND INFORMATION

6.1 The projects have and will continue to be communicated to the local community through local exhibitions and Council meetings.

7. LEGAL IMPLICATIONS

7.1 The Statutory Consultation will be completed in accordance with the Local Authorities Traffic Orders (Procedure) (England and Wales) Regulations 1996.

8. EQUALITY IMPACT ASSESSMENT

8.1 In addition to the Human Rights Act 1998 the Council is required to comply with the Equalities Act 2010. Section 149 of the Equalities Act 2010 requires the Council to have due regard to the need to:-

- eliminate discrimination, harassment, victimisation and any other conduct that is prohibited by or under this Act;
- advance equality of opportunity between persons who share a relevant protected characteristic and persons who do not share it;
- foster good relations between persons who share a relevant protected characteristic and persons who do not share it.

8.2 The Council has carried out an Equality Impact Assessment scoping exercise and considers that the proposals do not have a direct impact on any groups with protected characteristics. The document is attached as Appendix 3.

9. FINANCIAL IMPLICATIONS

9.1 None relating to this report.

10. BACKGROUND PAPERS

10.1 Traffic Management Sub-Committee reports.

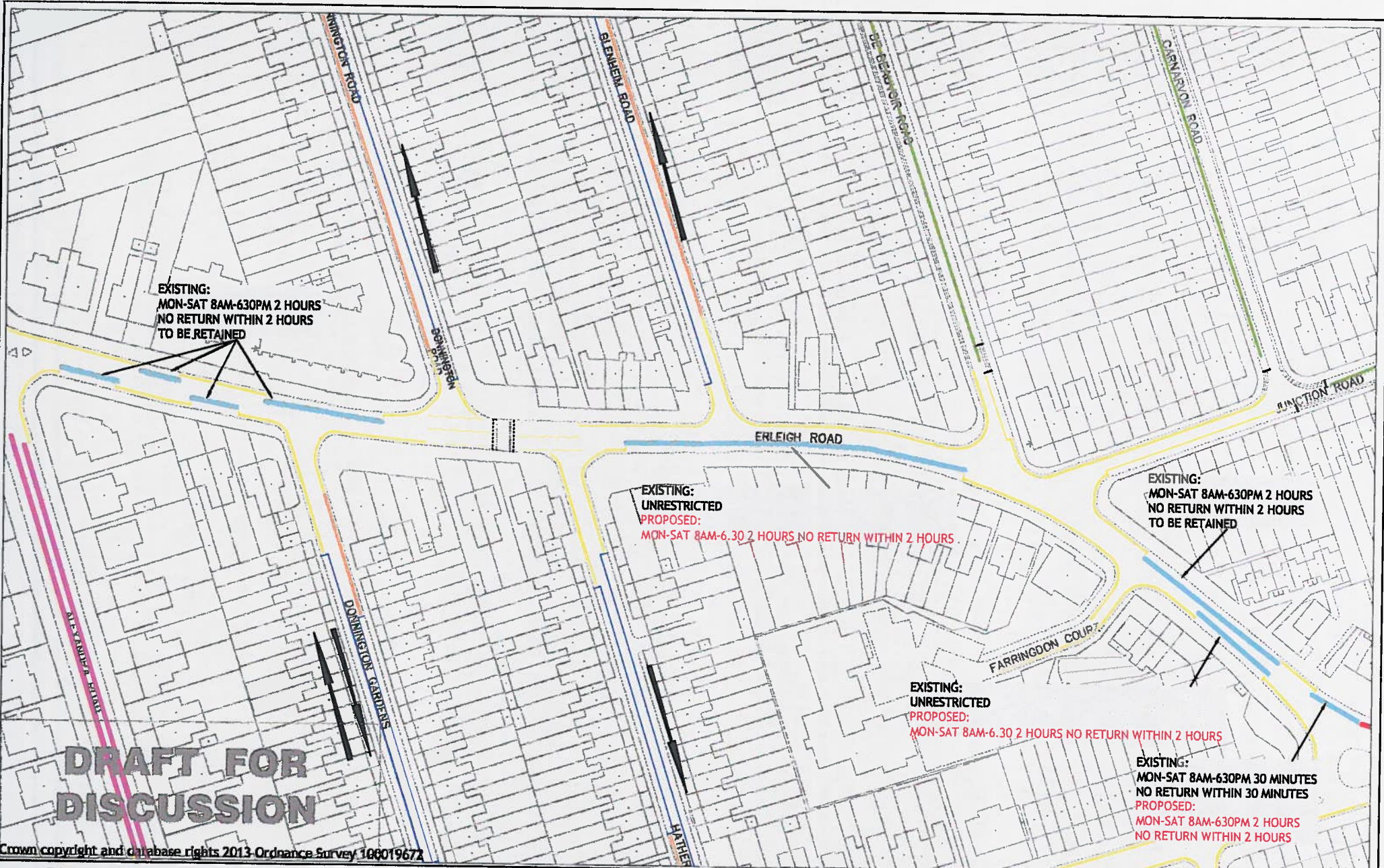

Reading
Borough Council

Working better with you

Transportation & Streetcare Services
Civic Offices
Bridge Street
Reading
RG1 2LU

Project
PARKING REVIEW
HOSPITAL & UNIVERSITY AREA

Drawing
ERLEIGH ROAD (BETWEEN
ALEXANDRA & ADDINGTON ROAD

Scale
N.T.S
Date
07.15

Drawn
Checked
Approved

Drawing No.
UH011/Erleigh/E/1

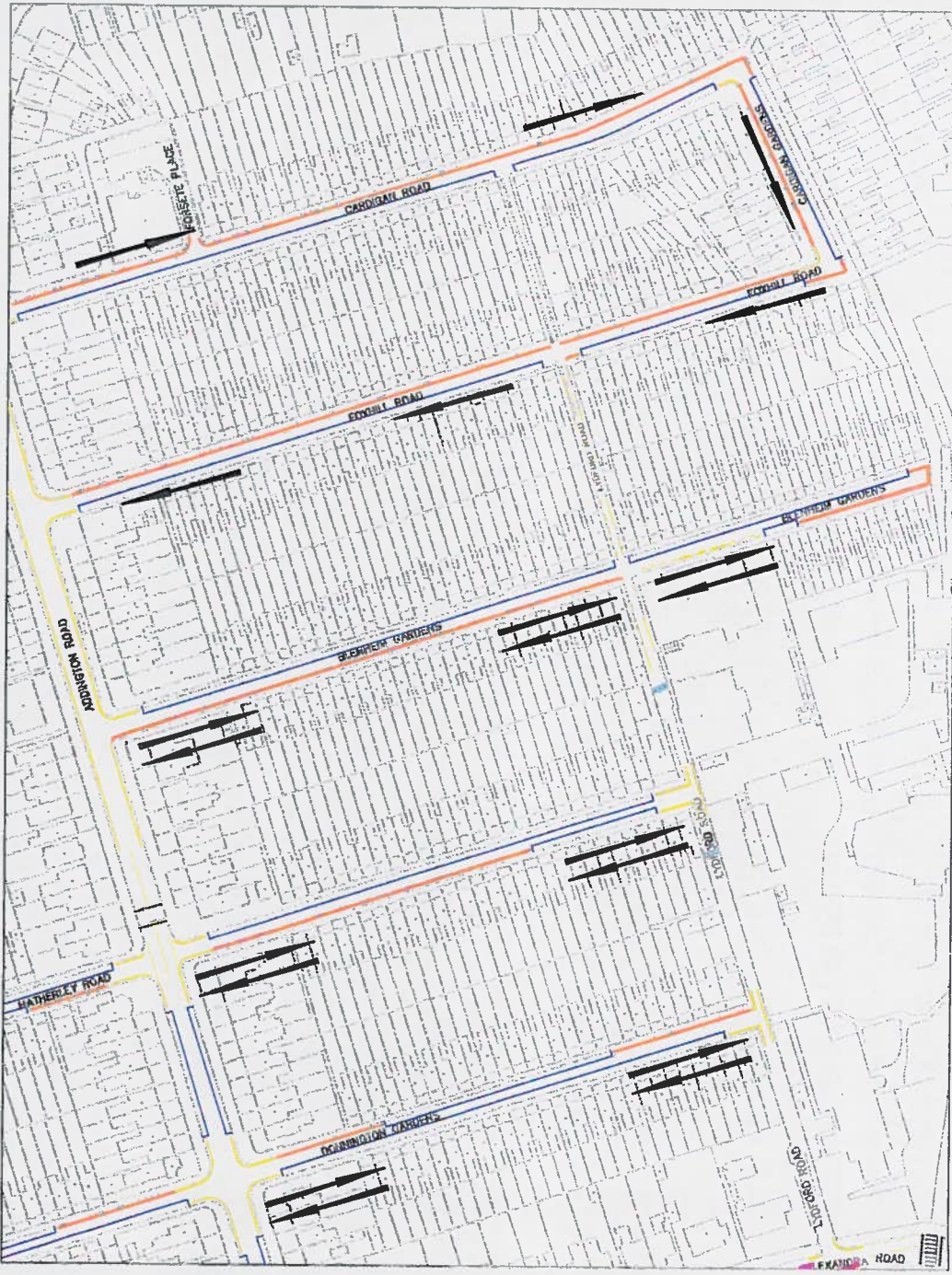

KEY

EXISTING RESTRICTIONS
 No Waiting At Any Time

PROPOSED RESTRICTIONS
 No Waiting At Any Time

Proposed Residents Parking Area
 (Residents Parking Only Mon-Fri 8am-530pm)



Reading
 Borough Council
 Working better with you RG1 2LU

Transportation & Streetcare Services
 Civic Offices
 Bridge Street
 Reading
 RG1 2LU

Project
 PARKING REVIEW
 HOSPITAL & UNIVERSITY AREA

Drawing
 OLD REDLANDS AREA
 PARKING PROTECTION

Scale
 N.T.S

Drawing no.
 UH110/OldRedlandsArea/1

Drawn KCB
Approved

Date 07.15
Rev
 B

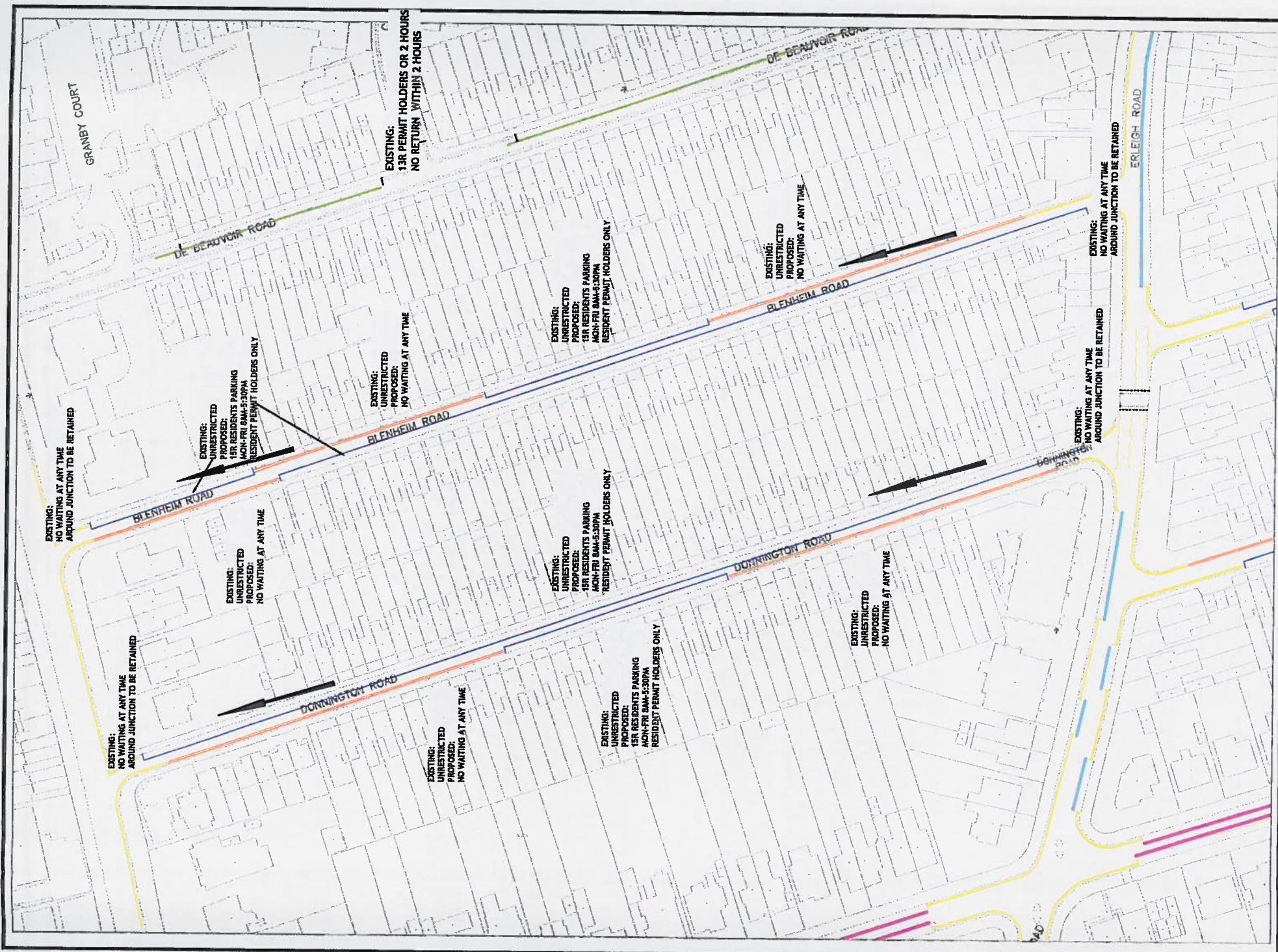

 Reading Borough Council Working better with you RG1 2LU	Project PARKING REVIEW HOSPITAL & UNIVERSITY AREA		Scale N.T.S	Drawn AS Approved Date 07.15	Checked
	Drawing no. UH111/Donnington/1		Rev B		
Transportation & Streetcare Services Civic Offices Bridge Street Reading RG1 2LU		Drawing DONNINGTON ROAD & BLENHEIM ROAD PARKING PROTECTION			

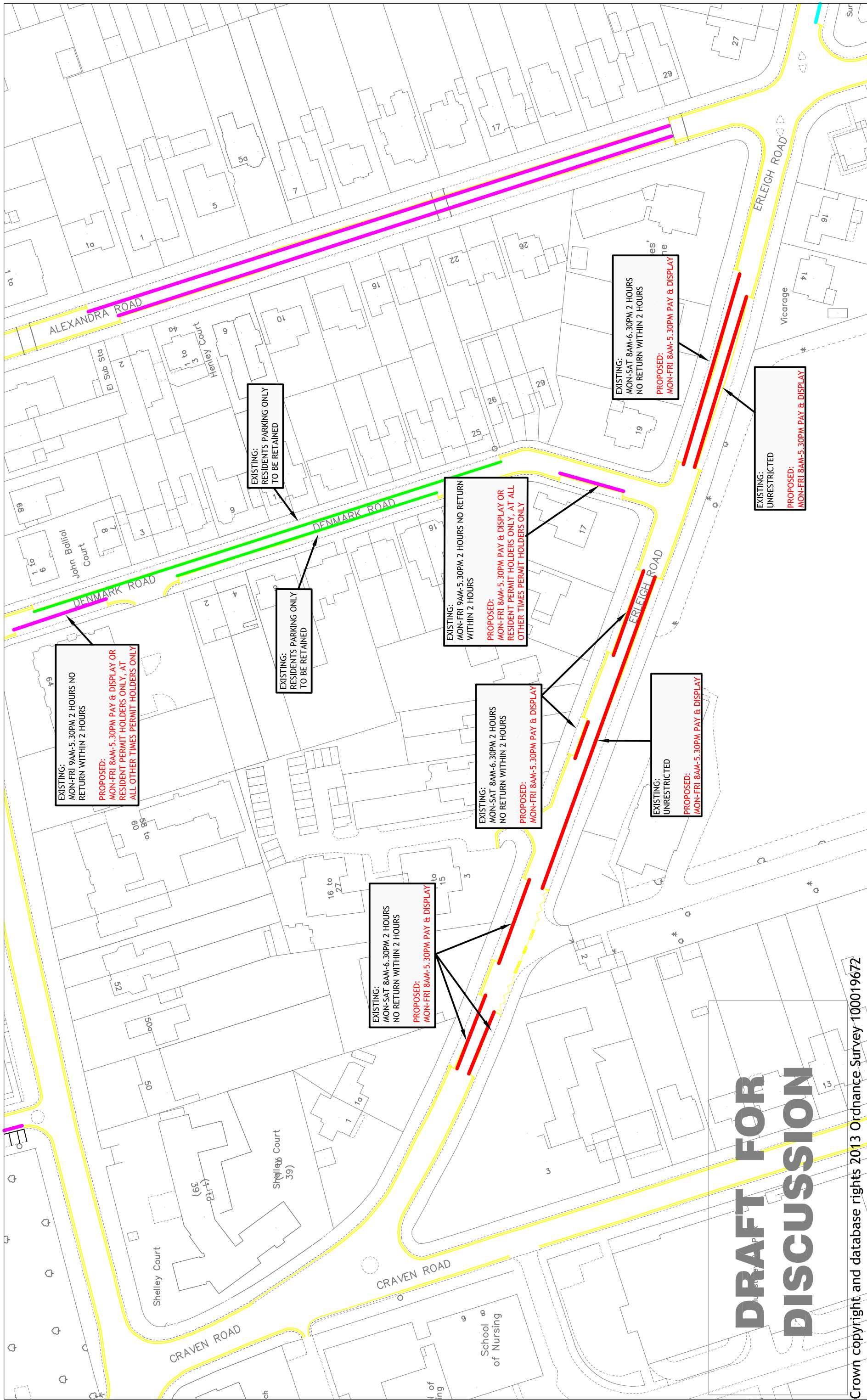

DRAFT FOR DISCUSSION

Crown copyright and database rights 2013 Ordnance Survey 100019672

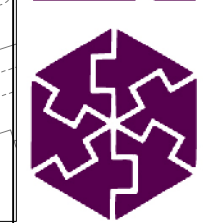

Reading
Borough Council
Working better with you

Transportation & Streetcare Services
Civic Offices
Bridge Street
Reading
RG1 2LU

Project
PARKING REVIEW
HOSPITAL & UNIVERSITY AREA

Scale
N.T.S
Date
07.15

Drawn
Checked
Approved

Drawing No.
UH005/Erleigh/1
Rev.
B

Drawing
ERLEIGH ROAD AND
DENMARK ROAD

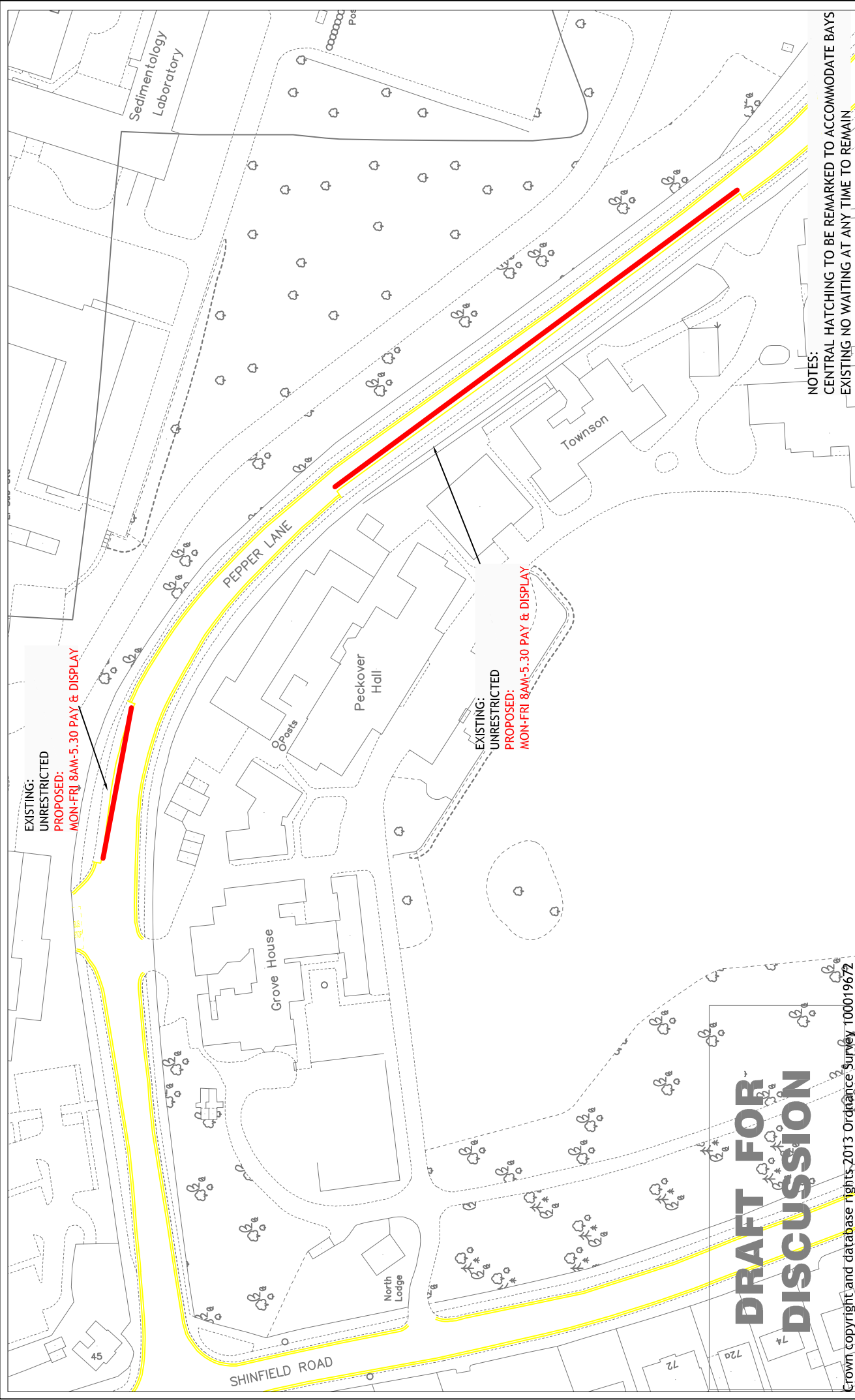

EXISTING:
UNRESTRICTED
PROPOSED:
MON-FRI 8AM-5.30 PAY & DISPLAY

EXISTING:
UNRESTRICTED
PROPOSED:
MON-FRI 8AM-5.30 PAY & DISPLAY

DRAFT FOR DISCUSSION

NOTES:
CENTRAL HATCHING TO BE REMARKED TO ACCOMMODATE BAYS
EXISTING NO WAITING AT ANY TIME TO REMAIN

Crown copyright and database rights 2013 Ordnance Survey 100019672

Project PARKING REVIEW HOSPITAL & UNIVERSITY AREA	Scale N.T.S	Drawn
	Date 07.15	Checked Approved
Drawing PEPPER LANE	Drawing No.	UH009/Pepper/1

Transportation & Streetcare Services
Civic Offices
Bridge Street
Reading
RG1 2LU



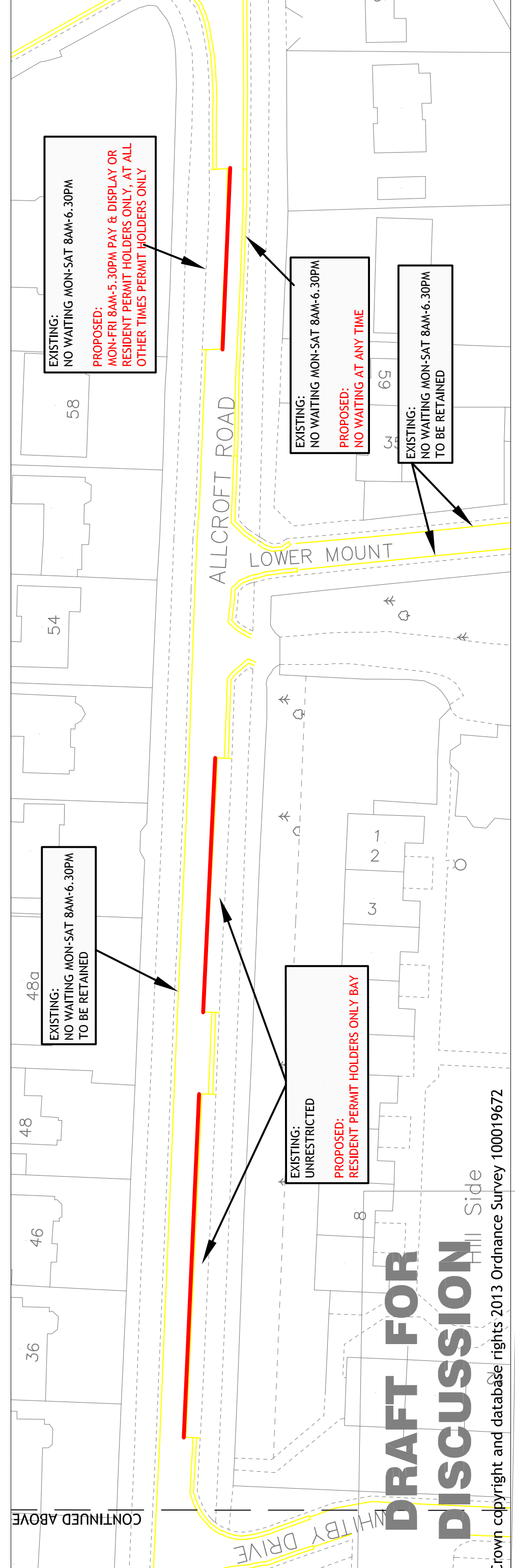
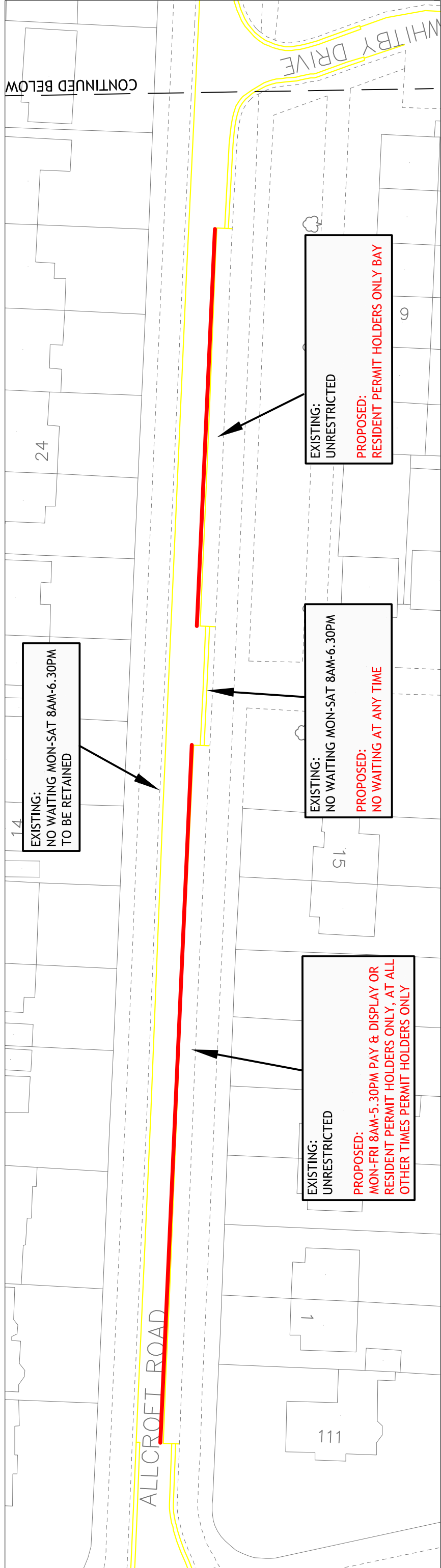

DRAFT FOR DISCUSSION Hill Side

Crown copyright and database rights 2013 Ordnance Survey 100019672



Reading
Borough Council
Working better with you

Transportation & Streetcare Services
Civic Offices
Bridge Street
Reading
RG1 2LU

Project PARKING REVIEW HOSPITAL & UNIVERSITY AREA	Scale N.T.S	Drawn
	Date 07.15	Checked
Drawing No. UH002/ALLCROFT/1	Approved	Rev. B

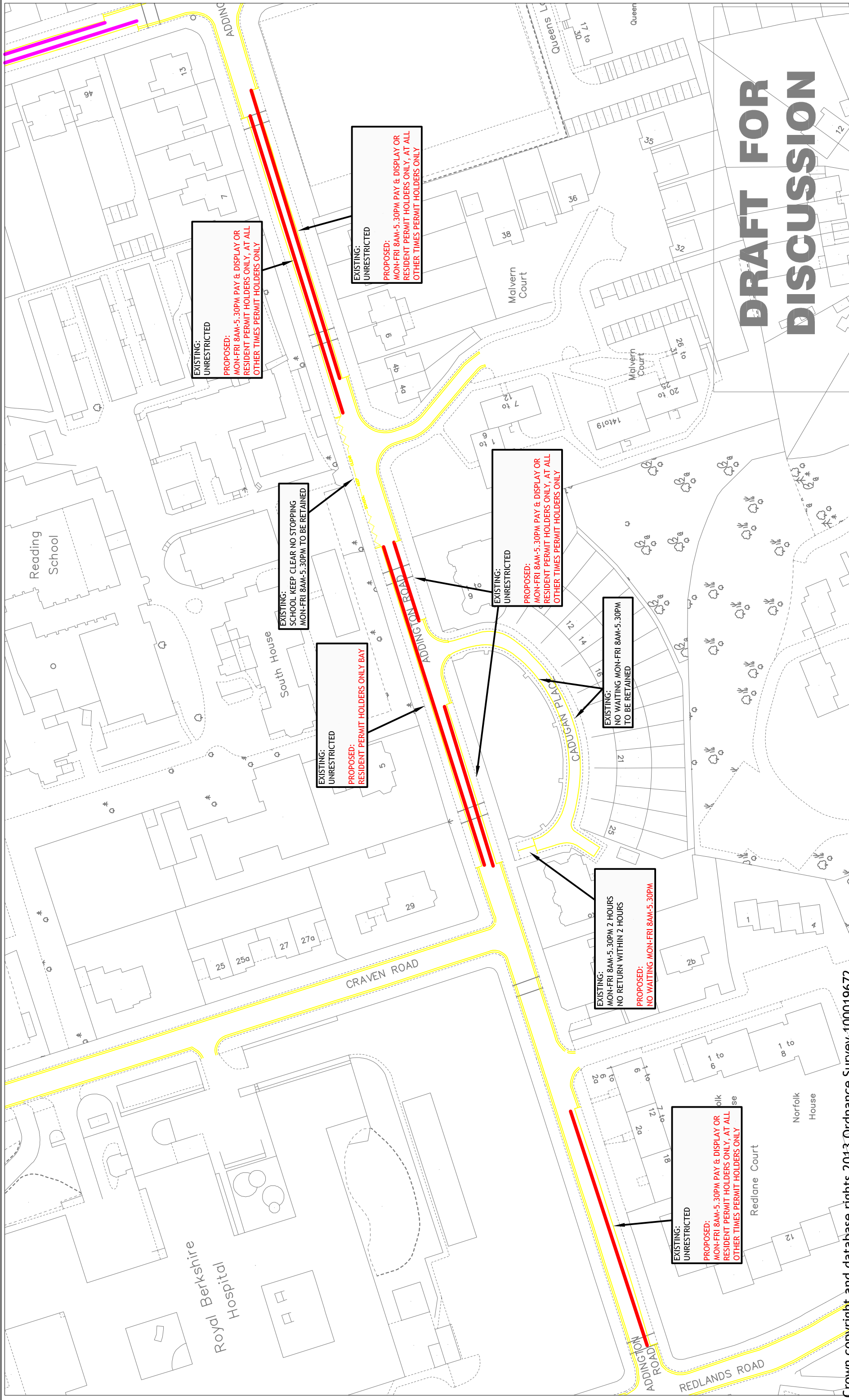

DRAFT FOR DISCUSSION

Crown copyright and database rights 2013 Ordnance Survey 100019672



Transportation & Streetcare Services
 Civic Offices
 Bridge Street
 Reading
 RG1 2LU

Project PARKING REVIEW HOSPITAL & UNIVERSITY AREA	Scale N.T.S	Drawn
	Date 07.15	Checked Approved
Drawing ADDINGTON ROAD (Between Redlands Rd & Alexandra Rd)	Drawing No. UH006/Addington/1	Rev. B

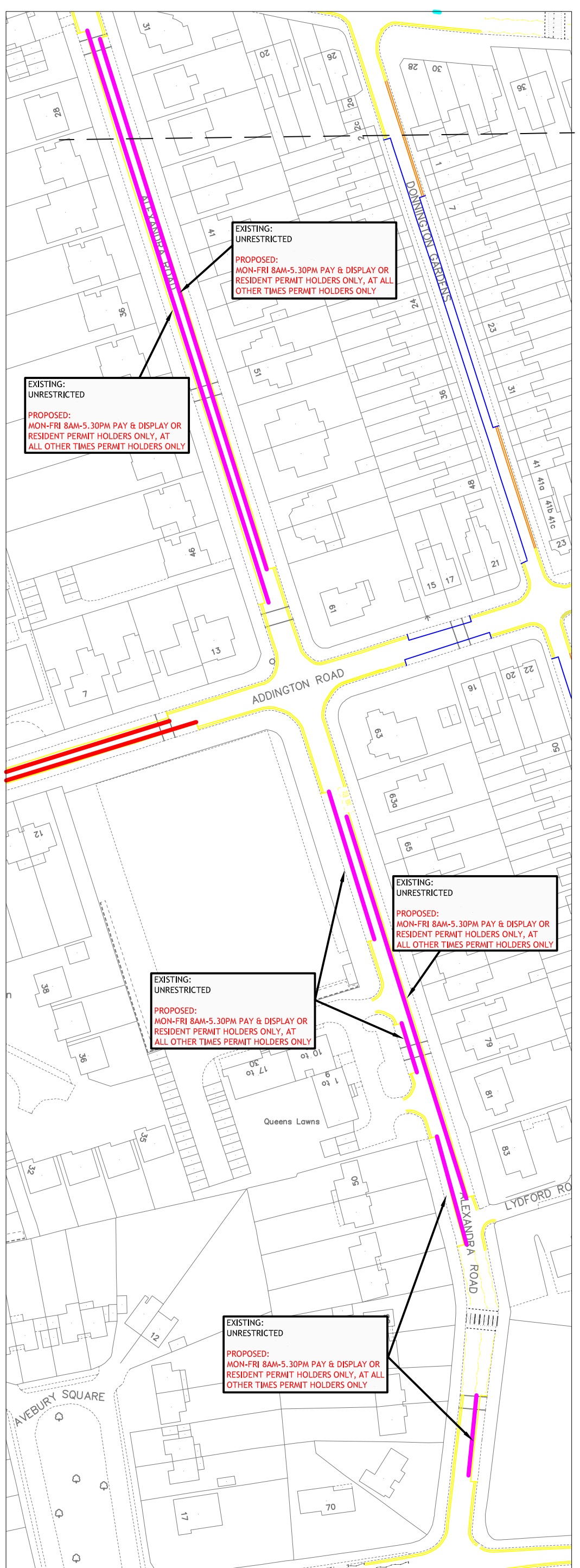
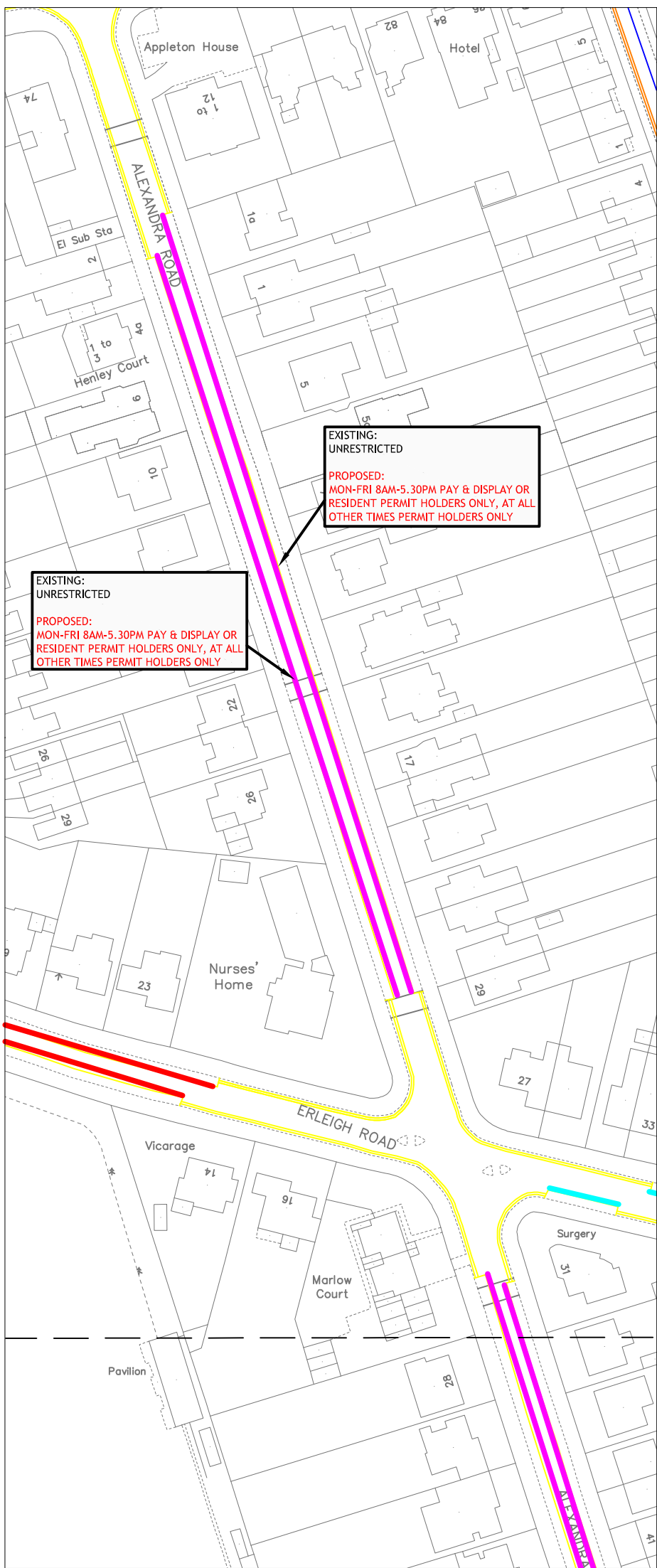

DRAFT FOR DISCUSSION



Reading
Borough Council
Working better with you

Transportation & Streetcare Services
Civic Offices
Bridge Street
Reading
RG1 2LU

Project
PARKING REVIEW
HOSPITAL & UNIVERSITY AREA
Drawing
ALEXANDRA ROAD

Scale
N.T.S

Drawn KCB | Checked
Approved
Date 07.15

Drawing no.
UH010/Alexandra/1

Rev
B

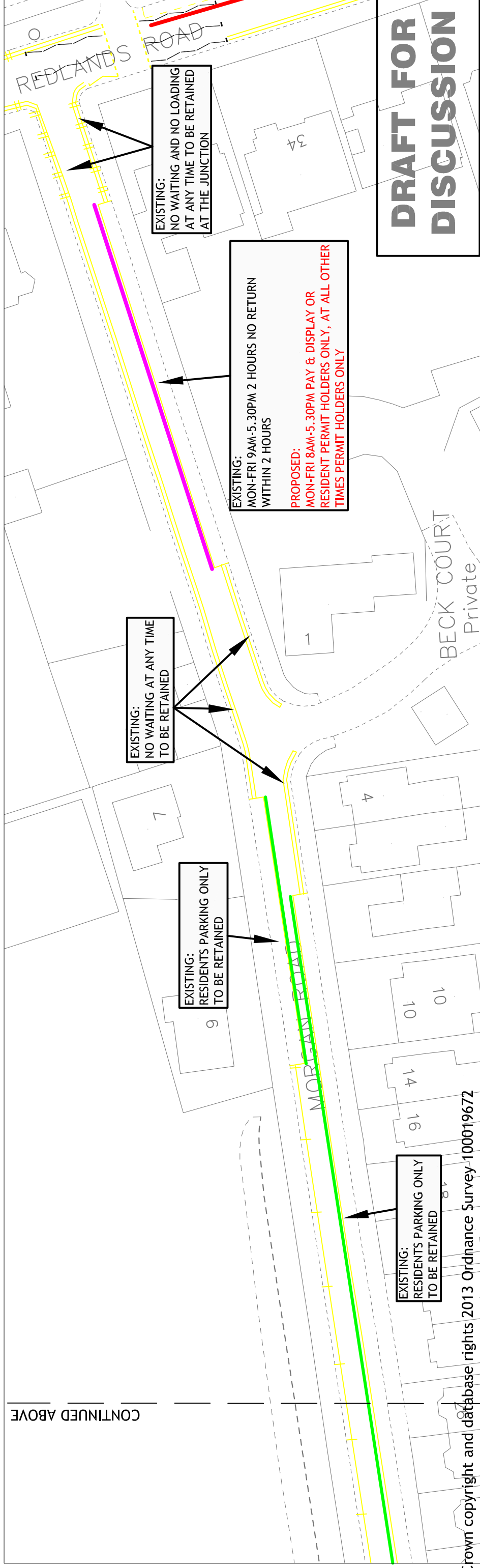
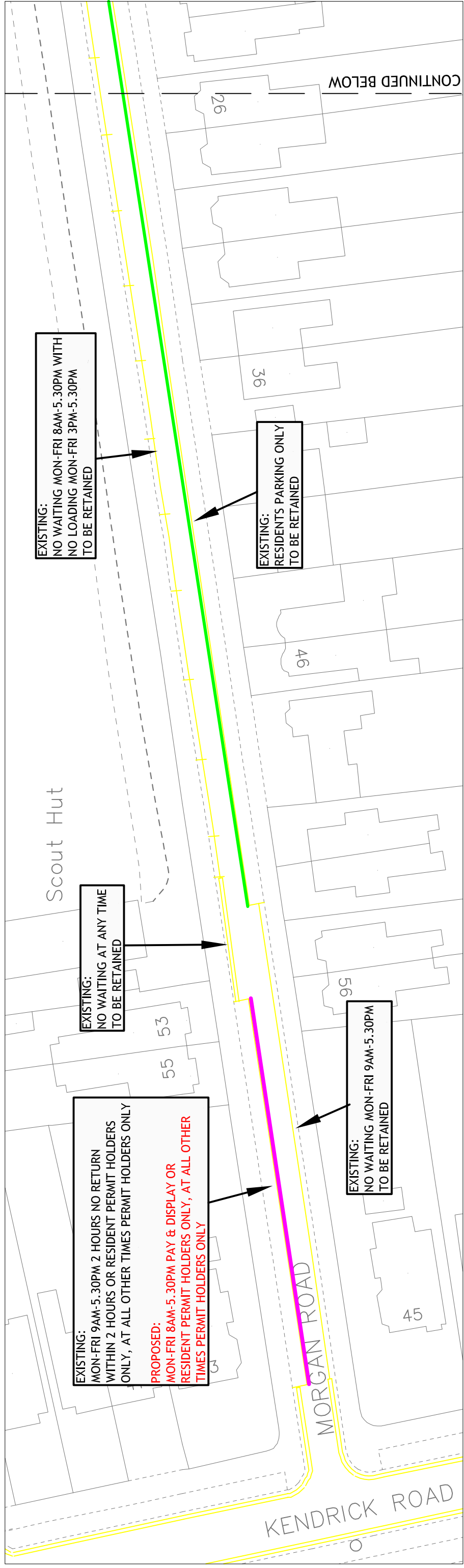

DRAFT FOR DISCUSSION

Scale	N.T.S	Drawn	
Date	07.15	Checked	
Approved		Approved	
Drawing No.	UH003/MORGAN/1		
Rev.	B		

Project
 PARKING REVIEW
 HOSPITAL & UNIVERSITY AREA
Drawing
 MORGAN ROAD

Crown copyright and database rights 2013 Ordnance Survey 100019672

Reading
 Borough Council
 Working better with you

Transportation & Streetcare Services
 Civic Offices
 Bridge Street
 Reading
 RG1 2LU

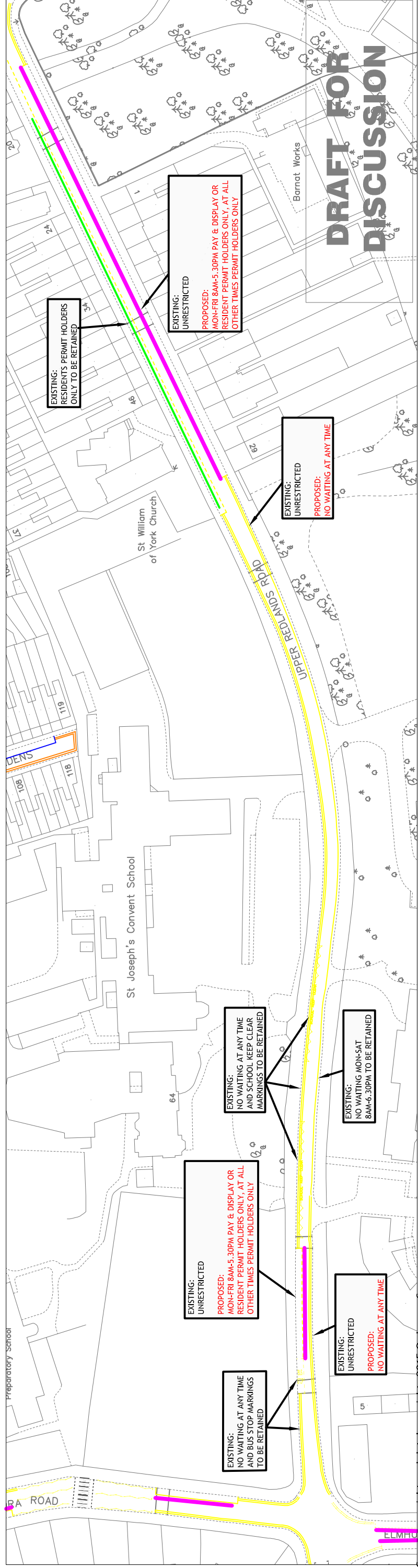
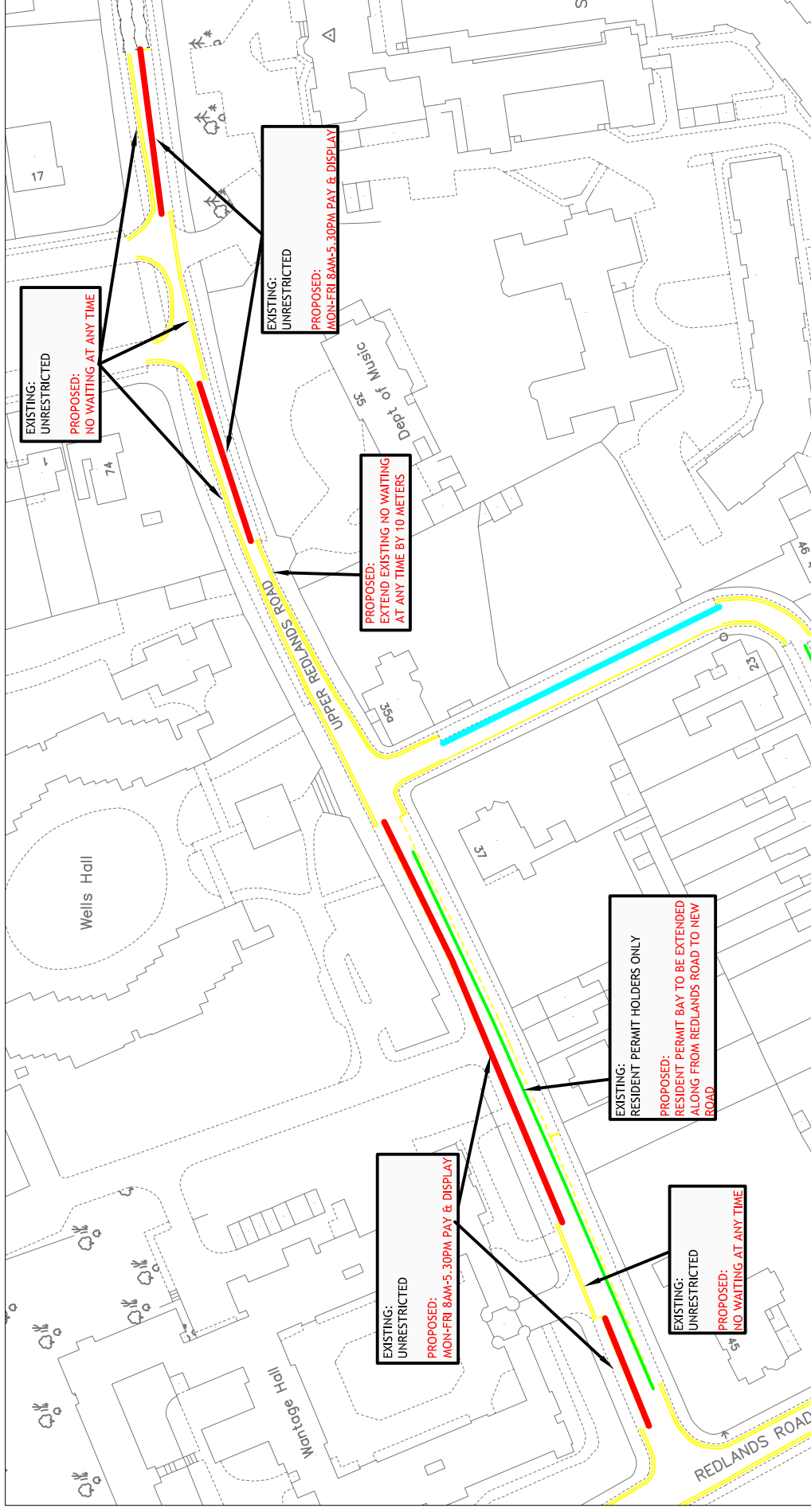

Crown copyright and database rights 2015 Ordnance Survey
100019672



Transportation & Streetcare Services
Civic Offices
Bridge Street
Reading
RG1 2LU

Project	PARKING REVIEW HOSPITAL & UNIVERSITY AREA	
Drawing	UPPER REDLANDS ROAD	

Scale	N.T.S	Drawn	Checked
Drawing no.	UH007/URR/1	Approved	
Rev	B	Date	07.15

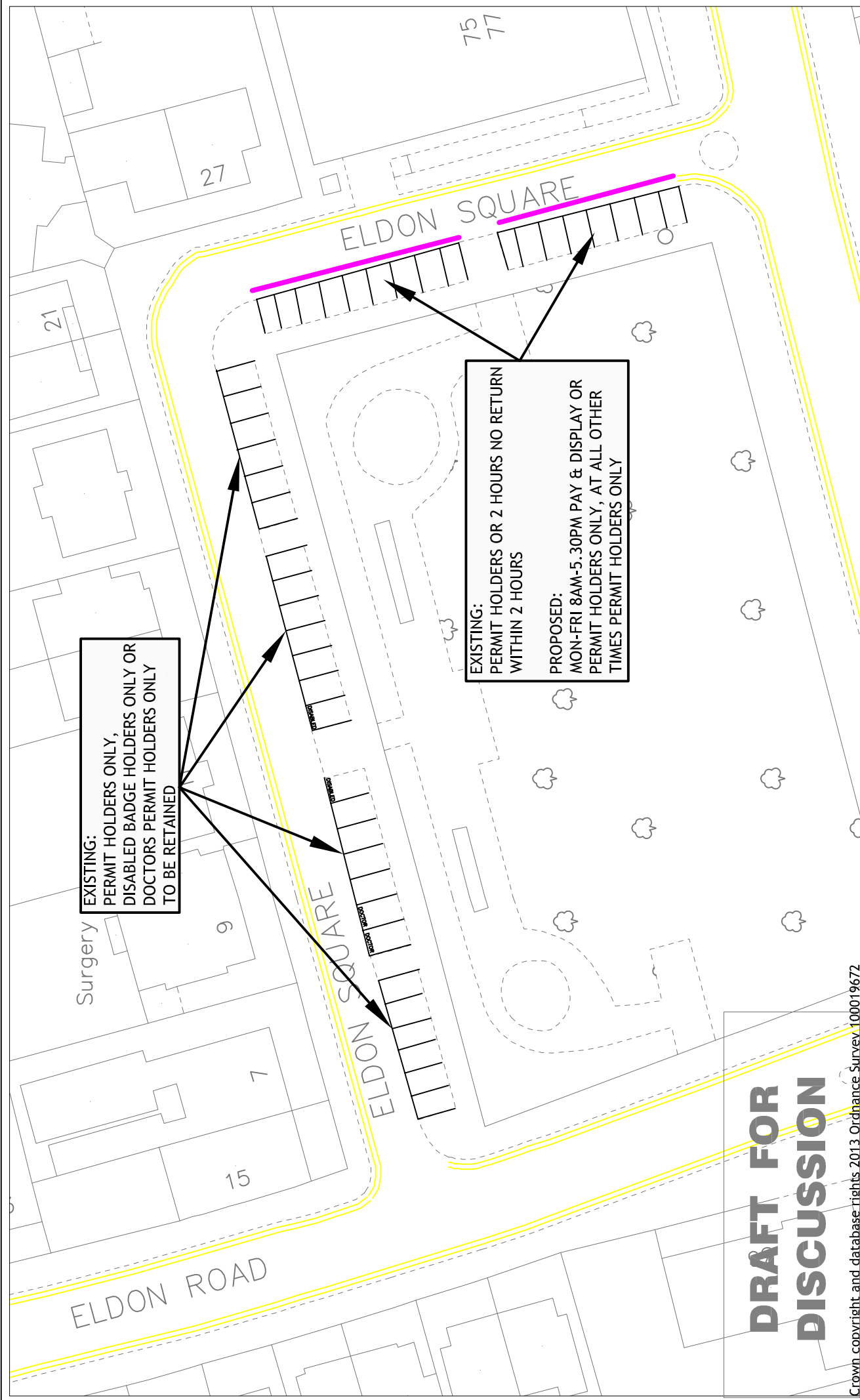

EXISTING:
 PERMIT HOLDERS ONLY,
 DISABLED BADGE HOLDERS ONLY OR
 DOCTORS PERMIT HOLDERS ONLY
 TO BE RETAINED

EXISTING:
 PERMIT HOLDERS OR 2 HOURS NO RETURN
 WITHIN 2 HOURS

PROPOSED:
 MON-FRI 8AM-5.30PM PAY & DISPLAY OR
 PERMIT HOLDERS ONLY, AT ALL OTHER
 TIMES PERMIT HOLDERS ONLY

**DRAFT FOR
 DISCUSSION**

Crown copyright and database rights 2013. Ordnance Survey 100019672



Reading
 Borough Council
 Working better with you

Transportation & Streetcare Services
 Civic Offices
 Bridge Street
 Reading
 RG1 2LU

Project	Scale	Drawn
	N.T.S	Checked
Drawing No.	Date	Approved
	07.15	
Project		UH012/Eldon/1
PARKING REVIEW HOSPITAL & UNIVERSITY AREA		
Drawing		
ELDON SQUARE		

OVERVIEW

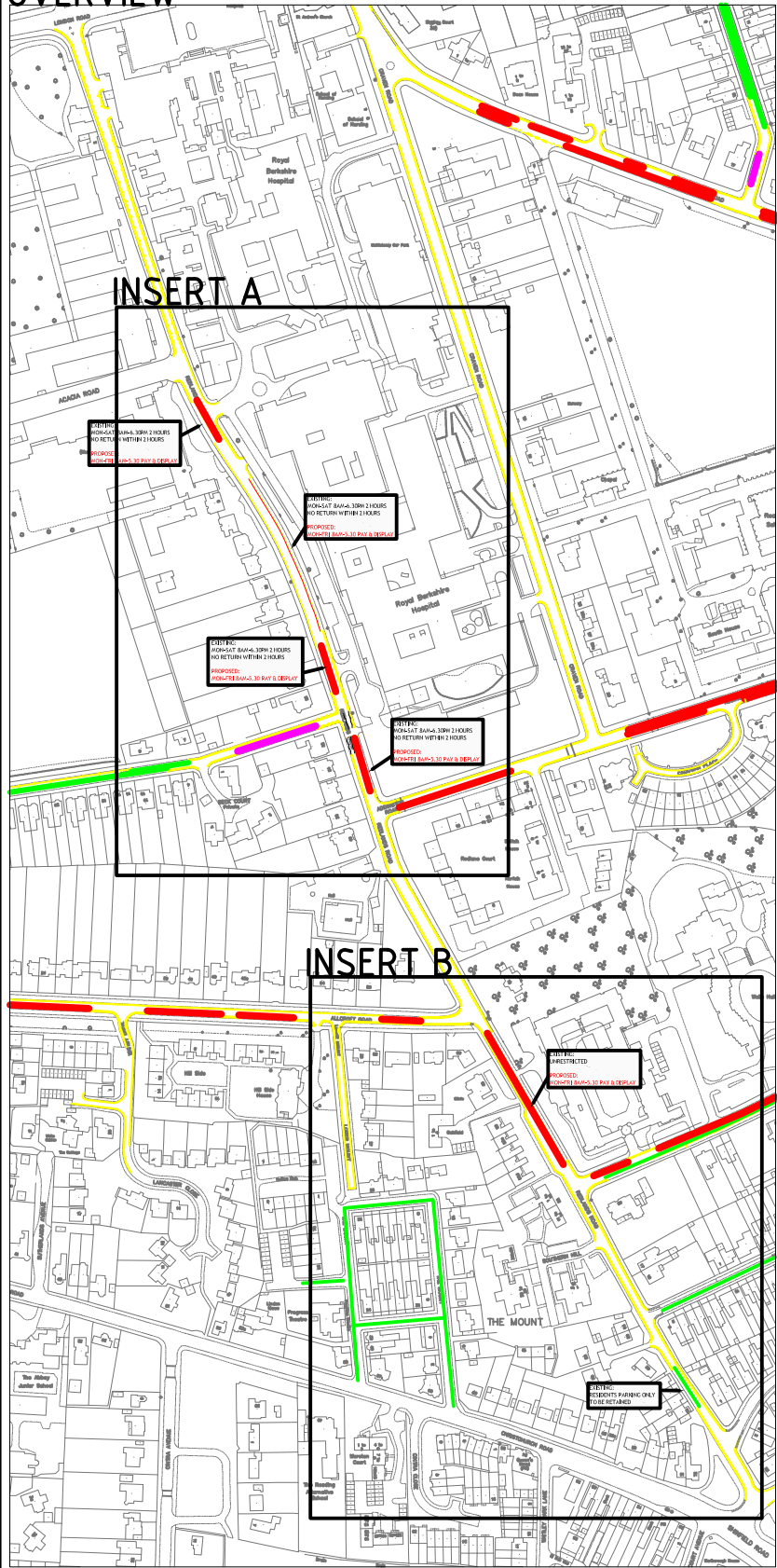

INSERT A

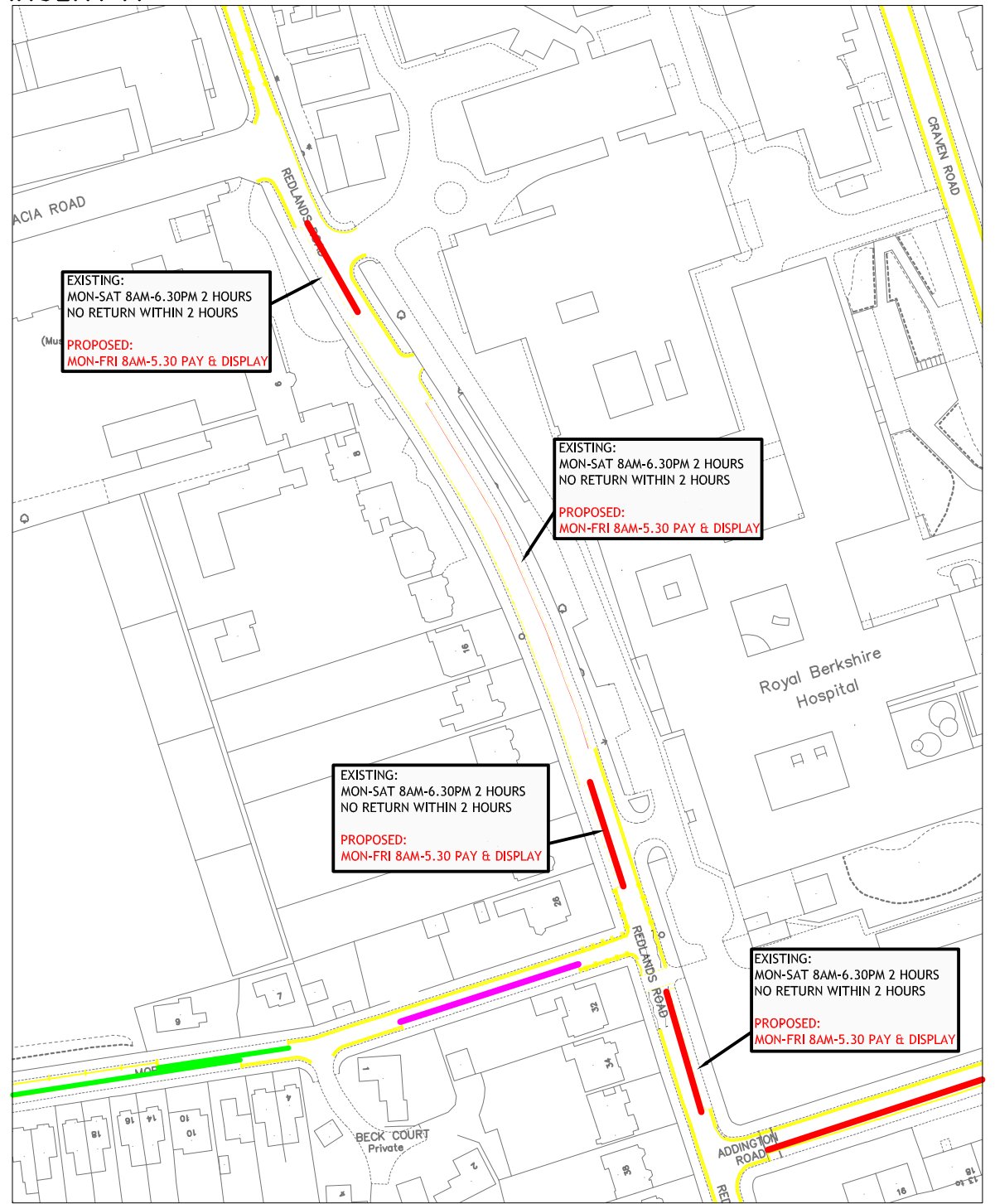

INSERT B

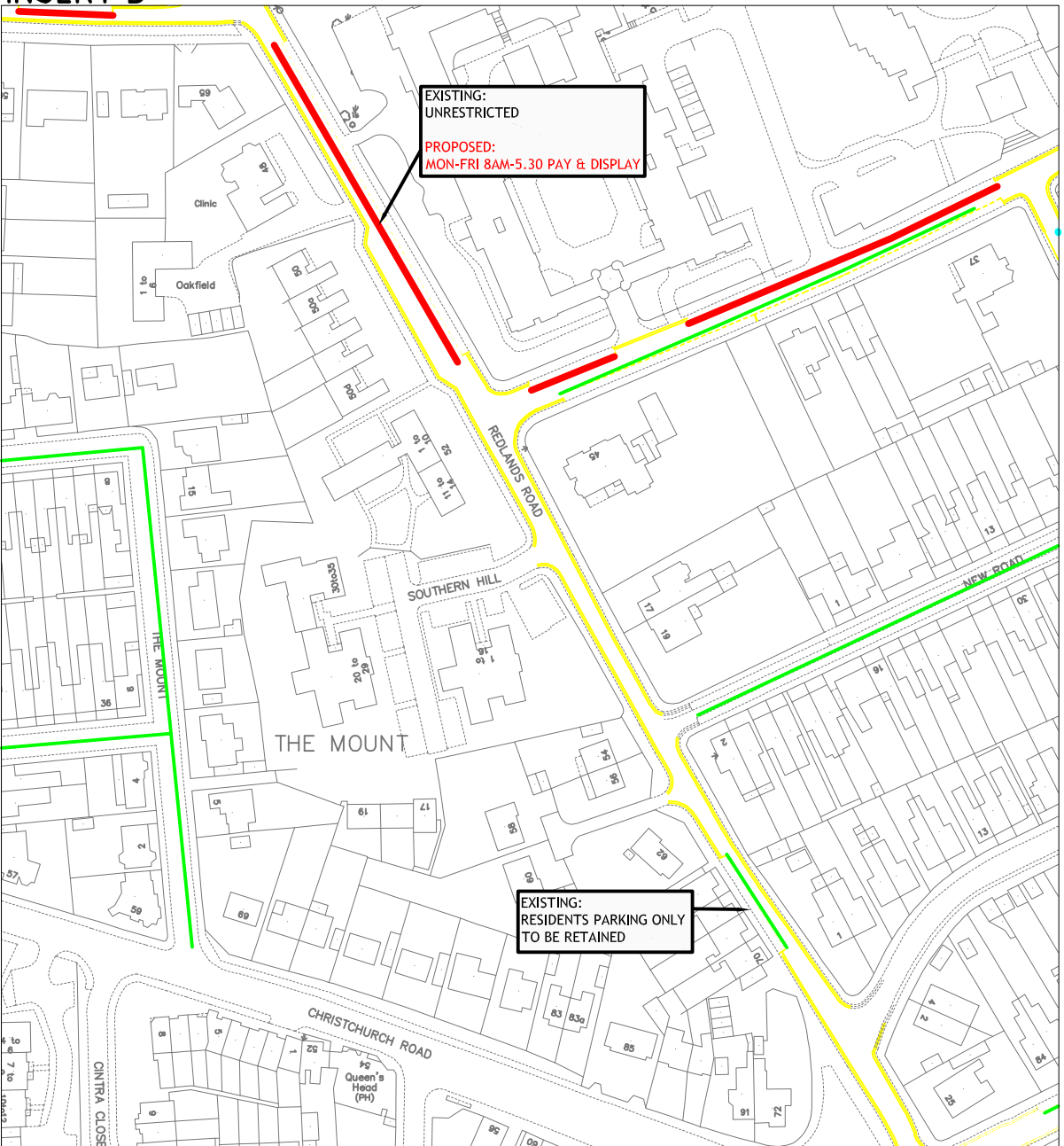

DRAFT FOR DISCUSSION

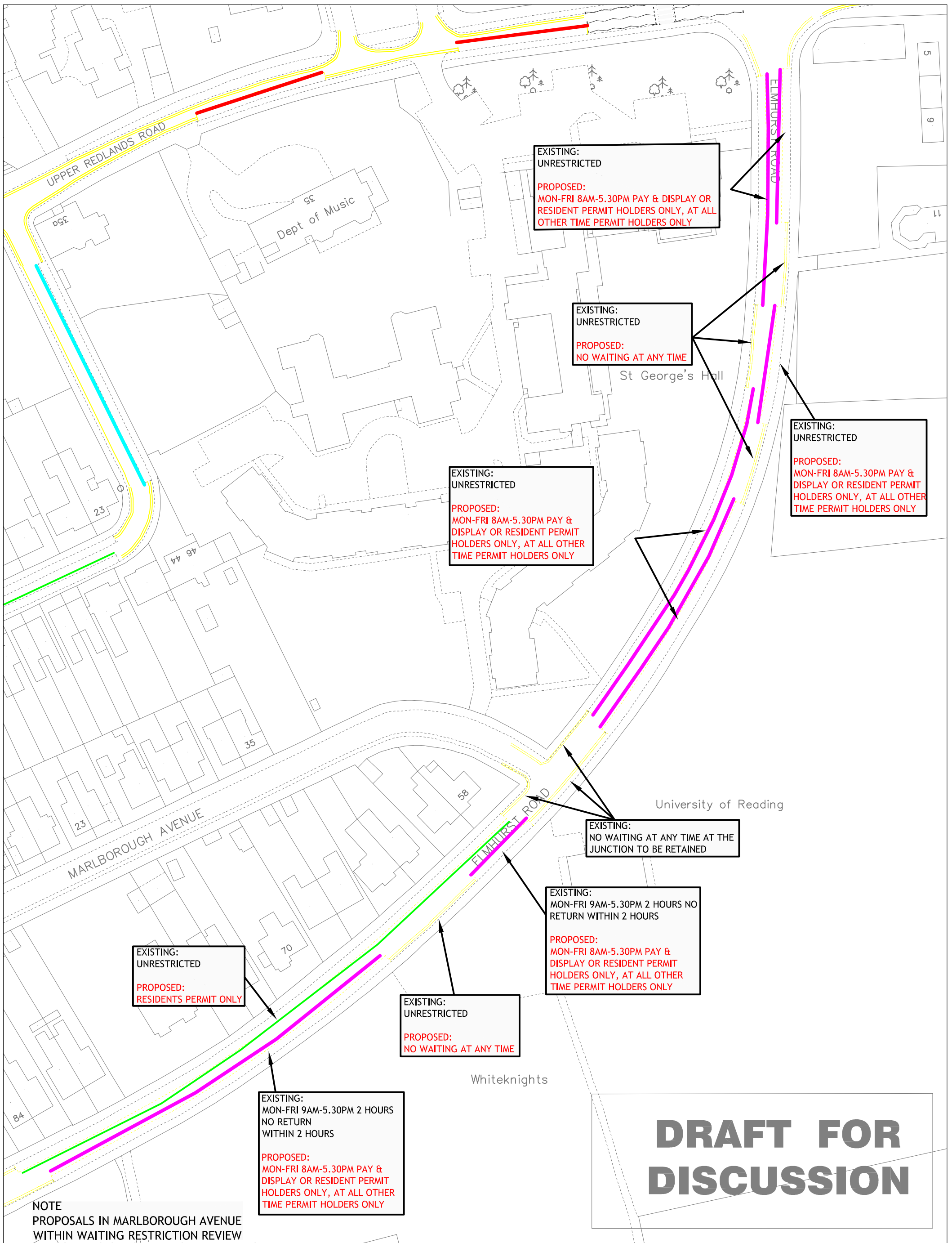

EXISTING:
UNRESTRICTED
PROPOSED:
RESIDENTS PERMIT ONLY

EXISTING:
MON-FRI 9AM-5.30PM 2 HOURS
NO RETURN
WITHIN 2 HOURS
PROPOSED:
MON-FRI 8AM-5.30PM PAY &
DISPLAY OR RESIDENT PERMIT
HOLDERS ONLY, AT ALL OTHER
TIME PERMIT HOLDERS ONLY

EXISTING:
UNRESTRICTED
PROPOSED:
NO WAITING AT ANY TIME

EXISTING:
MON-FRI 9AM-5.30PM 2 HOURS NO
RETURN WITHIN 2 HOURS
PROPOSED:
MON-FRI 8AM-5.30PM PAY &
DISPLAY OR RESIDENT PERMIT
HOLDERS ONLY, AT ALL OTHER
TIME PERMIT HOLDERS ONLY

EXISTING:
NO WAITING AT ANY TIME AT THE
JUNCTION TO BE RETAINED

EXISTING:
UNRESTRICTED
PROPOSED:
MON-FRI 8AM-5.30PM PAY &
DISPLAY OR RESIDENT PERMIT
HOLDERS ONLY, AT ALL OTHER
TIME PERMIT HOLDERS ONLY

EXISTING:
UNRESTRICTED
PROPOSED:
NO WAITING AT ANY TIME

EXISTING:
UNRESTRICTED
PROPOSED:
MON-FRI 8AM-5.30PM PAY & DISPLAY OR
RESIDENT PERMIT HOLDERS ONLY, AT ALL
OTHER TIME PERMIT HOLDERS ONLY

EXISTING:
UNRESTRICTED
PROPOSED:
MON-FRI 8AM-5.30PM PAY &
DISPLAY OR RESIDENT PERMIT
HOLDERS ONLY, AT ALL OTHER
TIME PERMIT HOLDERS ONLY

NOTE
PROPOSALS IN MARLBOROUGH AVENUE
WITHIN WAITING RESTRICTION REVIEW

**DRAFT FOR
DISCUSSION**

Crown copyright and database rights 2013 Ordnance Survey 100019672



Reading
Borough Council
Working better with you

Transportation &
Streetcare Services
Civic Offices
Bridge Street
Reading RG1 2LU

Project
PARKING REVIEW
HOSPITAL & UNIVERSITY AREA
Drawing
ELMHURST ROAD

Scale
N.T.S
Date
07.15

Drawn
Checked
Approved

Drawing No.
UH008/Elmhurst/1/

Rev.
B

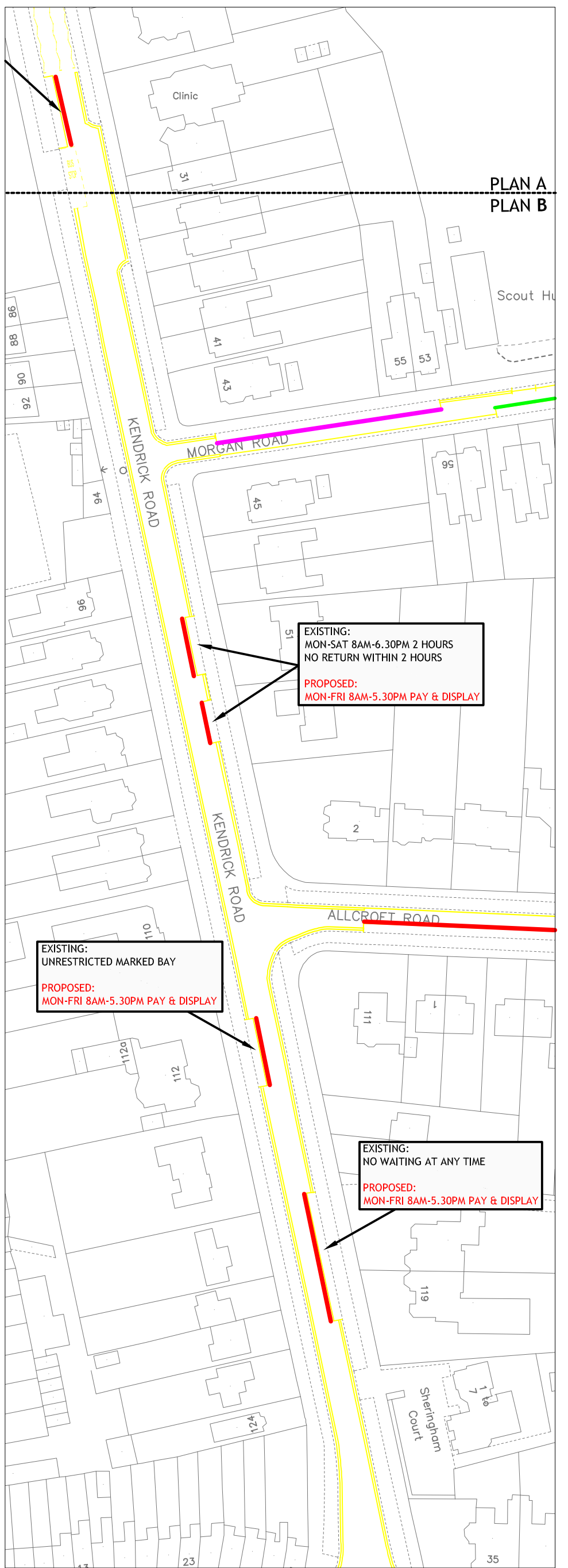
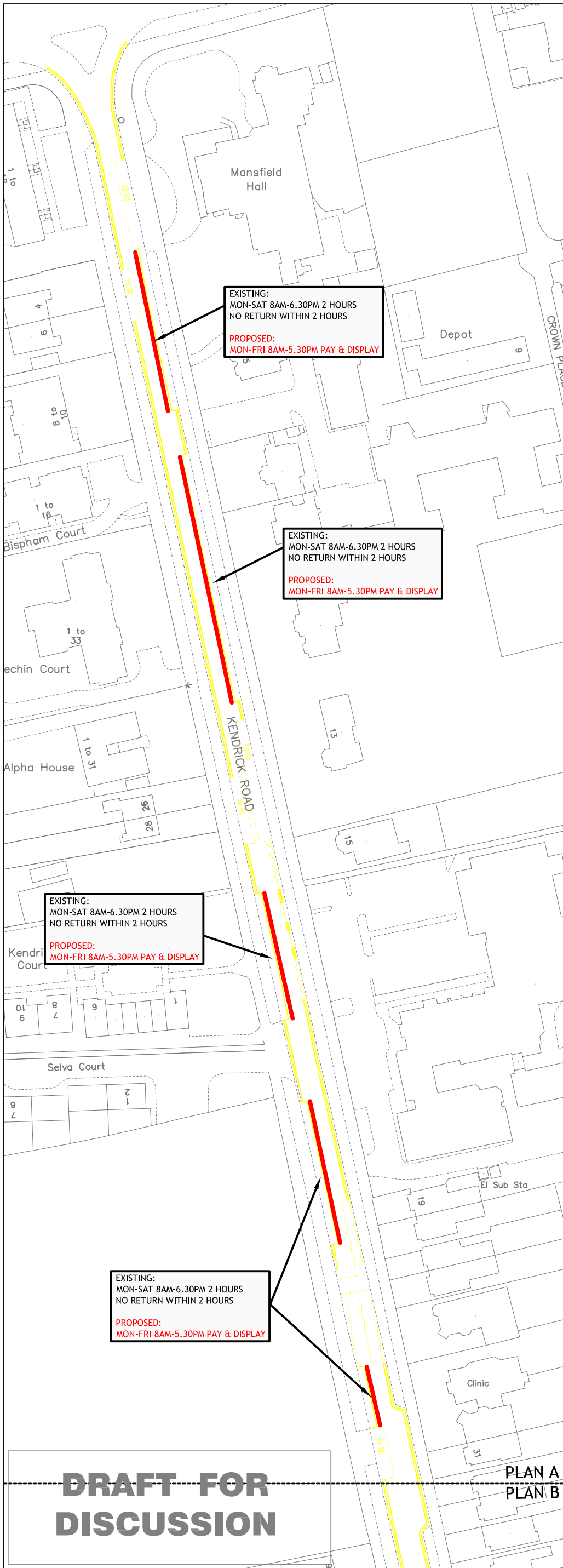

NOTES:
ALL EXISTING NO WAITING AT ANY TIME,
SCHOOL KEEP CLEAR MARKINGS & BUS STOPS
TO REMAIN IN SITU EXCEPT WHERE NOTED

**DRAFT FOR
DISCUSSION**



Provide basic details

Name of proposal/activity/policy to be assessed: Proposed residents parking and pay and display parking restrictions in the vicinity of the Royal Berkshire Hospital and Reading University

Directorate: ~~Children, Education & Early Help Services / Adult Care & Health Services / DENS / CSS (delete as appropriate)~~

Service: Transport

Name and job title of person doing the assessment

Name: Cris Butler

Job Title: Strategic Transport Programme Manager

Date of assessment: November 2015

Scope your proposal

What is the aim of your policy or new service/what changes are you proposing?

To implement a series of new parking restrictions in the vicinity of the Royal Berkshire Hospital and Reading University Area to prioritise parking for local residents and service users through introducing a Residents' Parking Scheme, to include elements of pay and display parking and parking protection at or near junctions.

Who will benefit from this proposal and how?

The residents and visitors of the area will benefit from a managed residents parking system and a pay and display facility that will create a higher turnaround of parking spaces. The proposed restrictions will also improve road safety by protecting junctions.

What outcomes does the change aim to achieve and for whom?

As above.

Who are the main stakeholders and what do they want?

Residents, visitors and users of facilities in the vicinity of the Royal Berkshire Hospital and Reading University.

Parking protection for residents and their visitors. More short term parking facilities for visitors to the Hospital and University.

Assess whether an EqlA is Relevant

How does your proposal relate to eliminating discrimination; promoting equality of opportunity; promoting good community relations?

Do you have evidence or reason to believe that some (racial, disability, gender, sexuality, age and religious belief) groups may be affected differently than others? (Think about your monitoring information, research, national data/reports etc.)

Yes / No (delete as appropriate)

Is there already public concern about potentially discriminatory practices/impact or could there be? Think about your complaints, consultation, and feedback.

Yes / No (delete as appropriate)

If the answer is **Yes** to any of the above you need to do an Equality Impact Assessment.

If **No** you **MUST** complete this statement

An Equality Impact Assessment is not relevant because: the proposals will improve parking facilities and parking space turnaround for all users in the vicinity of the Royal Berkshire Hospital and Reading University.

Signed (completing officer)

Date November 2015



Signed (Lead Officer)

Date November 2015